

A background image of a university campus. In the foreground, a wide, light-colored paved walkway curves through a green lawn. Several people, including students with backpacks, are walking along the path. In the mid-ground, more people are visible, some sitting on benches. The background is filled with large, mature trees with dense green foliage. A brick building is partially visible through the trees on the right side. The sky is bright with some light clouds.

# IUP LONG RANGE FACILITIES MASTER PLAN UPDATE

---

**PLAN PRESENTATION**

---

**OPEN FORUM – APRIL 02, 2024**

# TODAY'S CONVERSATION

The background image shows a university campus scene. In the foreground, several students are sitting on the grass, some looking at papers or laptops. In the background, there is a large, multi-story brick building with many windows and a prominent entrance. The scene is set outdoors with trees and a clear sky.

**PROCESS RECAP**

**SPACE ANALYSIS SUMMARY**

**PLAN GOALS & PREFERRED SCENARIO**

**PHASING & SEQUENCING**

**DISCUSSION**

A photograph of a large, multi-story brick building with a white balcony, set against a backdrop of trees with autumn foliage. A red rectangular box is overlaid in the center of the image, containing the text "PROCESS RECAP" in white, bold, uppercase letters. The scene is captured during the day with soft lighting.

## PROCESS RECAP

# PROCESS



- Site Visits
- Pop-up Engagement Sessions
- Stakeholder Interviews
- Campus & Community Open Sessions
- MapMyIUP Survey
- Space Analysis

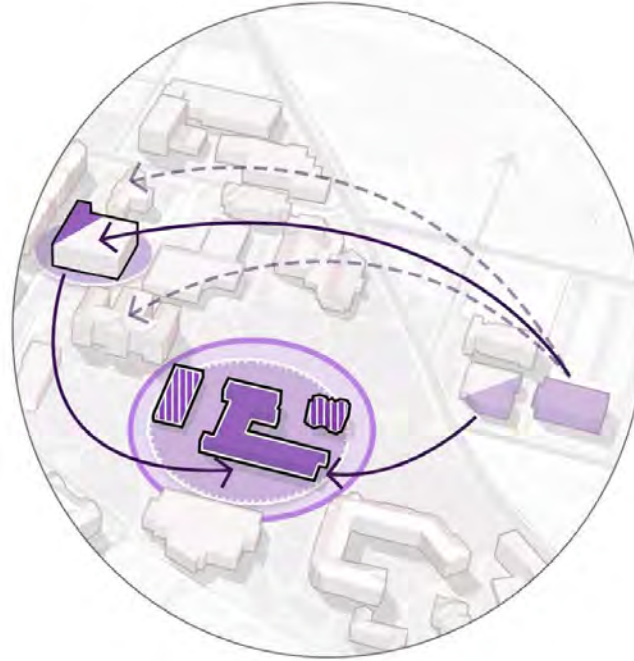

- Design Charrettes
- Plan Goals
- Alternative Scenarios



- Preferred Scenario
- Proposed Projects
- Project Sequencing
- Implementation Phasing
- LRFMP Report Document



# OUTREACH & ENGAGEMENT

## CAMPUS POP-UPS, OPEN FORUMS & FOCUS GROUPS

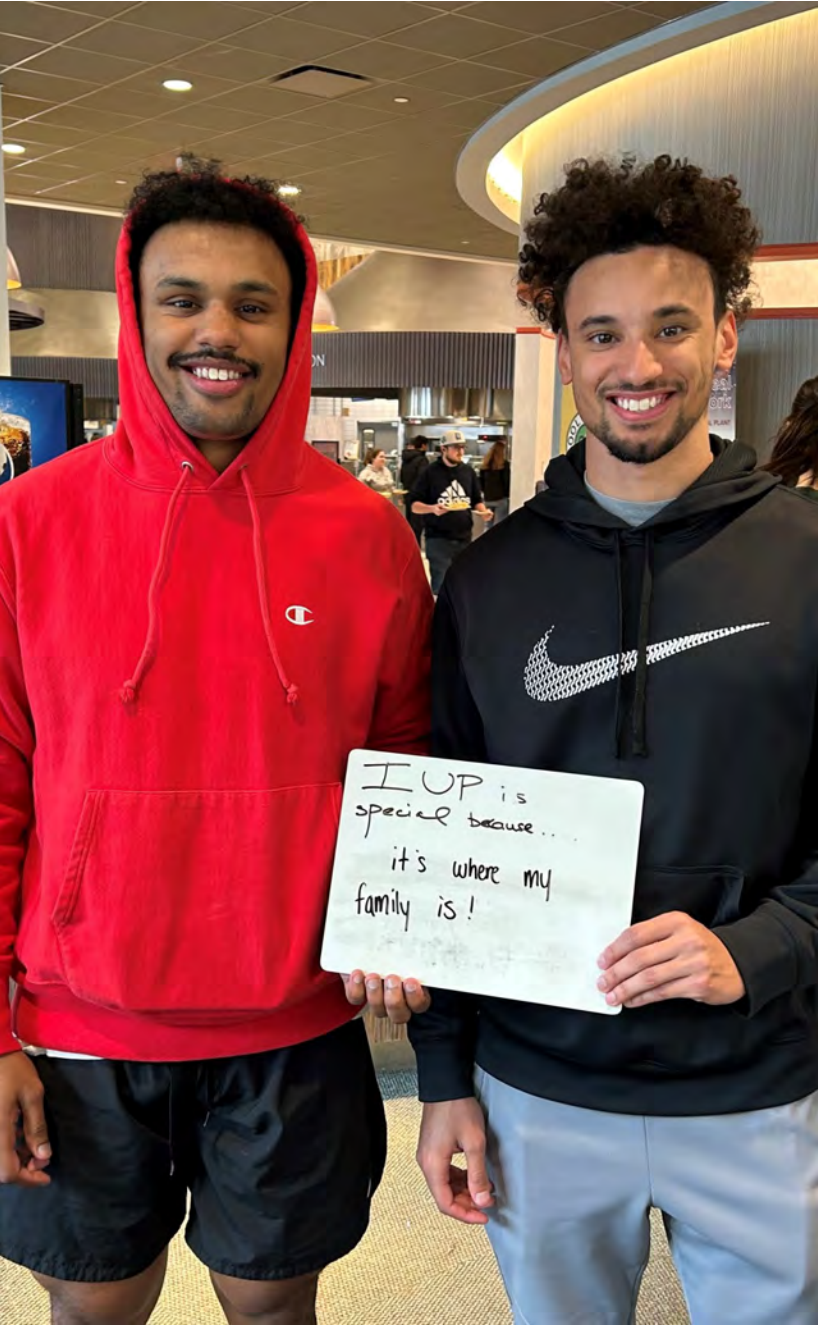
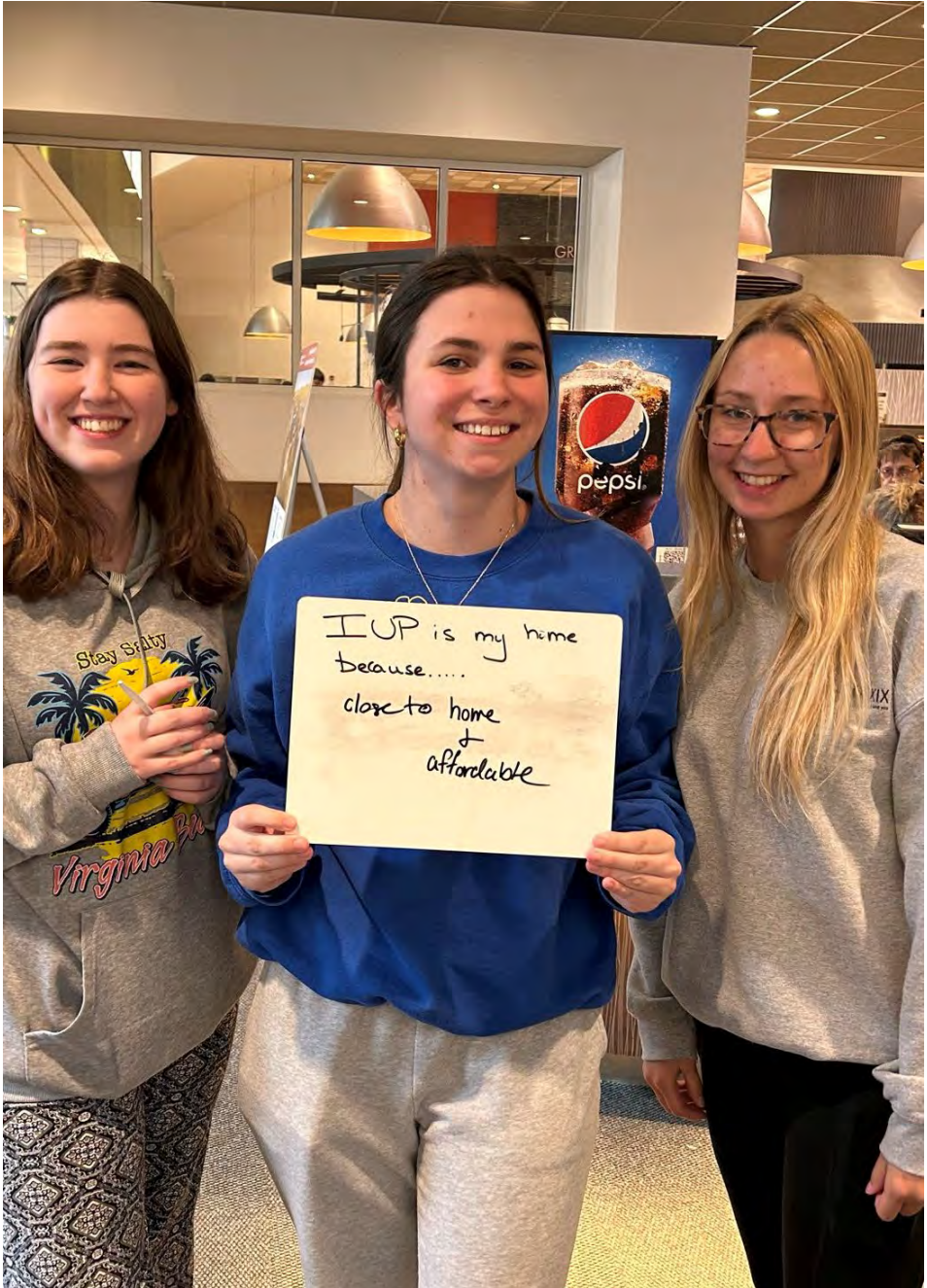



# OUTREACH & ENGAGEMENT

MapMyIUP

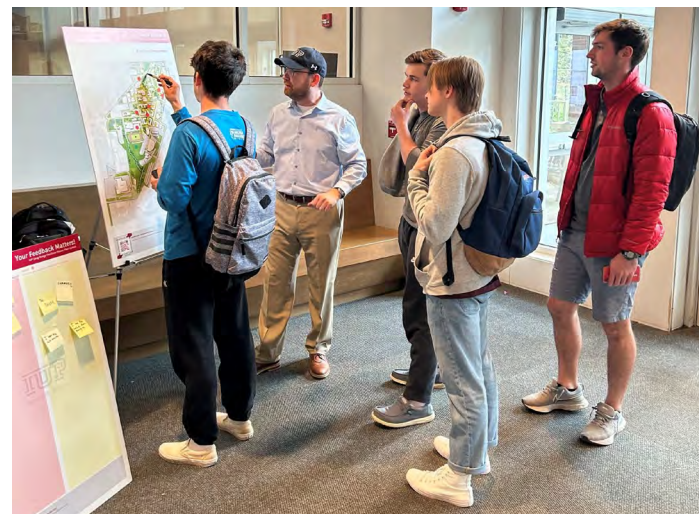
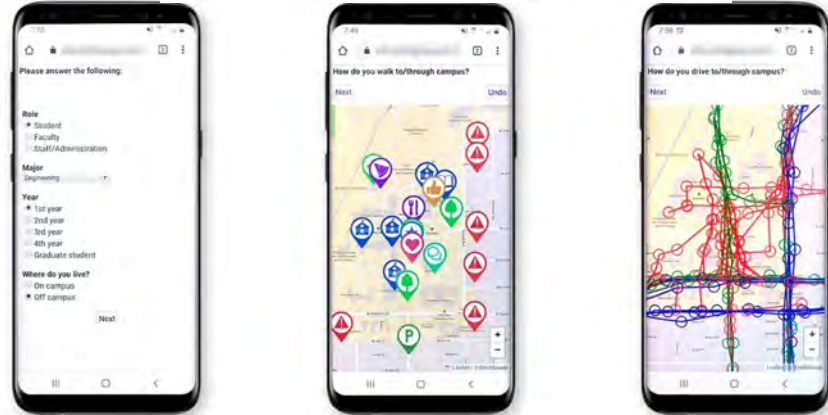

**TOTAL Responses**  
465 Students  
86 Faculty  
130 Staff  
477 Community

**465** MapMyIUP STUDENT RESPONSES

**3** COMMUNITY OPEN SESSIONS

**200+** STUDENT PARTICIPANTS IN POP-UP SESSIONS

**10** CAMPUS OPEN SESSIONS

**2** DESIGN CHARRETTES

**216** MapMyIUP FACULTY AND STAFF RESPONSES

**477** MapMyIUP COMMUNITY RESPONSES

**1** LONG-RANGE FACILITY MASTER PLAN UPDATE



# MAP MY IUP

WHAT AREA OF CAMPUS BEST REPRESENTS THE CULTURE AND IDENTITY OF IUP?

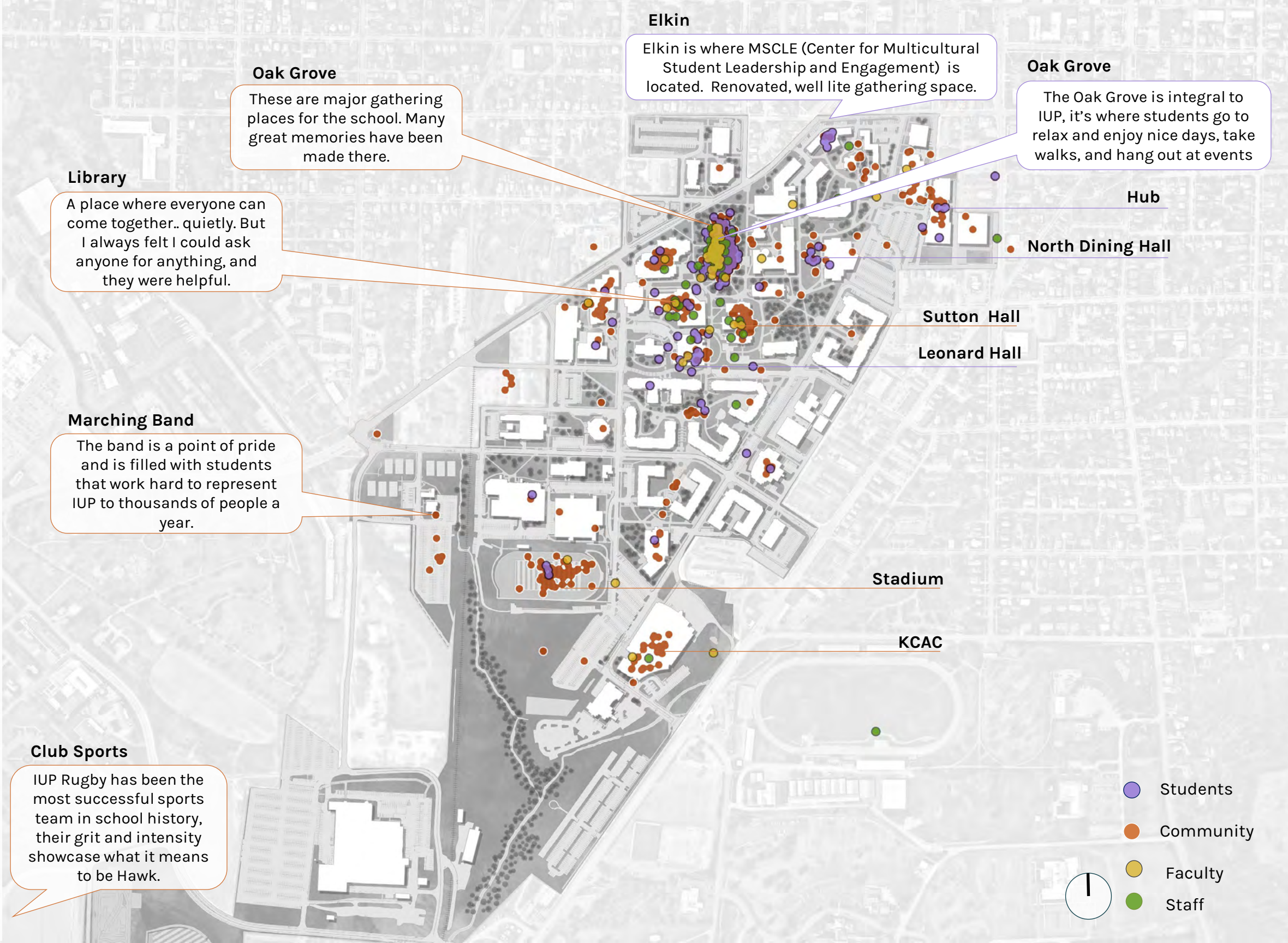
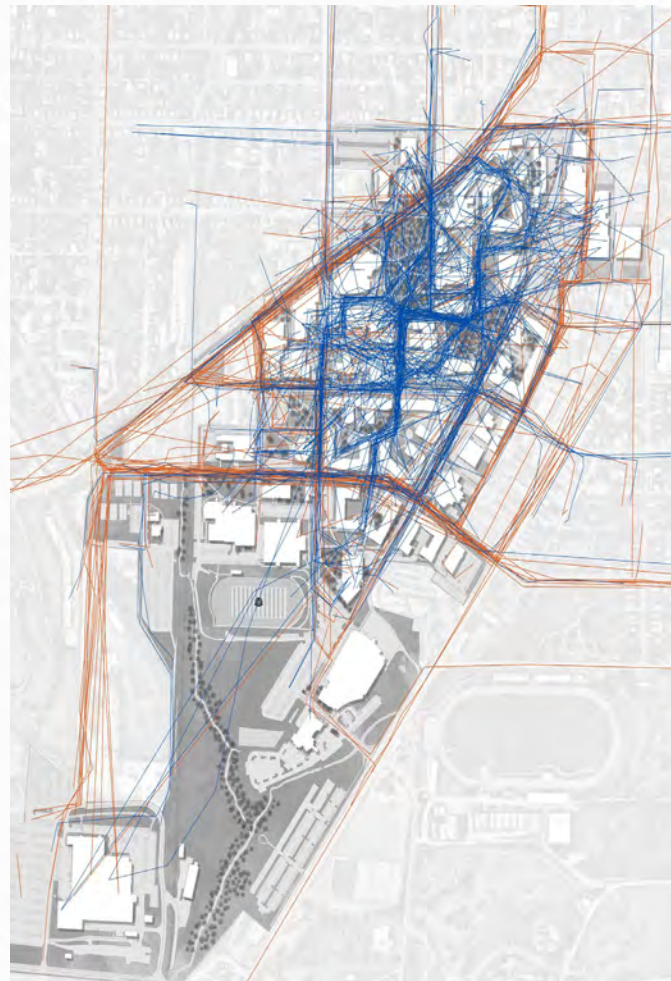



# PLAN GOALS



## OPTIMIZING EFFICIENCY

Identify Opportunities to Increase Efficiency and Utilization of Existing Spaces Across Campus



## ACADEMIC FUTURE

Enrich the Academic Environment through Strategic Programmatic Moves and Building Renovations and plan for the new College of Osteopathic Medicine



## STUDENT SUCCESS & WELLBEING

Elevate Student Experience by Creating a One-Stop Precinct for a Welcome Center, Admissions, and Student Success Facilities



## CAMPUS COMMUNITY

Improve Facilities for Housing, Dining, Student Organizations, Recreation, and Athletics



## MOVING AROUND CAMPUS

Provide Safe Pedestrian Routes and Green Space Network across the Campus



## CAMPUS & THE BOROUGH

Create Welcoming Campus Edges and Explore Partnerships and Alumni/Donor Engagement Opportunities





## SPACE ANALYSIS

# PLANNING ASSUMPTIONS

## ENROLLMENT & PERSONNEL

	Fall 2022	Target
<b>Enrollment</b>	<b>8,510</b>	<b>9,230</b>
Undergraduate Students	6,732	6,986
Graduate Students	1,778	2,244
<b>Personnel</b>	<b>1,186</b>	<b>983</b>
Faculty	660	546
Staff	526	437

# TARGET YEAR CAMPUS BUILDING CHANGES

<b>New Construction</b>	<b>86,505 ASF</b>
-------------------------	-------------------

Kopchick Science Building	86,505 ASF
---------------------------	------------

<b>Demolition</b>	<b>174,677 ASF</b>
-------------------	--------------------

Reschini House	2,392 ASF
Weyandt Hall	95,235 ASF
Eicher Building	13,534 ASF
Pratt Hall	22,325 ASF
R&P Office Building	4,939 ASF
University Towers	36,252 ASF

<b>Demolition Potential (assumed in analysis)</b>	<b>158,588 ASF</b>
---	--------------------

Davis Hall	47,312 ASF
Elkin Hall	45,250 ASF
Whitmyre Hall	40,253 ASF
Ackerman Hall	25,773 ASF



# SPACE NEED

## 2022

Student Headcount = 8,510  
Staff Headcount = 1,186

## Target

Student Headcount = 9,230  
Staff Headcount = 983

Space Category	Existing ASF	Guideline ASF	Surplus/ (Deficit)	Percent Surplus/ (Deficit)	Projected Existing ASF	Guideline ASF	Surplus/ (Deficit)	Percent Surplus/ (Deficit)
<b>Academic Space</b>								
Classrooms	135,395	76,968	58,427	43%	105,818	83,176	22,642	21%
Teaching Laboratories	163,043	83,149	79,894	49%	130,172	87,824	42,348	33%
Open Laboratories	34,159	39,642	(5,483)	(16%)	25,805	42,065	(16,260)	(63%)
Research Laboratories	30,365	54,170	(23,805)	(78%)	48,835	45,480	3,355	7%
<b>Academic Space Subtotal</b>	<b>362,962</b>	<b>253,929</b>	<b>109,033</b>	<b>30%</b>	<b>310,630</b>	<b>258,545</b>	<b>52,085</b>	<b>17%</b>
<b>Academic Support Space</b>								
Academic Offices	191,182	130,510	60,672	32%	134,745	112,830	21,915	16%
Administrative Offices	174,509	46,965	127,544	73%	174,041	42,745	131,296	75%
Library & Collaborative Learning Space	114,228	124,691	(10,463)	(9%)	117,590	128,159	(10,569)	(9%)
Assembly & Exhibit	65,332	48,510	16,822	26%	64,672	52,830	11,842	18%
Other Department Space	73,173	42,550	30,623	42%	52,999	46,150	6,849	13%
<b>Academic Support Space Subtotal</b>	<b>618,424</b>	<b>393,226</b>	<b>225,198</b>	<b>36%</b>	<b>544,047</b>	<b>382,714</b>	<b>161,333</b>	<b>30%</b>
<b>Other Space</b>								
Recreation & Athletics	172,772	196,300	(23,528)	(14%)	172,260	212,908	(40,648)	(24%)
Day Care	10,334	10,334	0	0%	0	10,334	(10,334)	(100%)
Physical Plant	103,994	69,446	34,548	33%	102,835	50,473	52,362	51%
Residence Life	803,339	562,500	240,839	30%	771,027	630,000	141,027	18%
Health Care Facilities	3,786	4,255	(469)	(12%)	3,786	4,615	(829)	(22%)
Convention Center	29,578	29,578	0	0%	29,578	29,578	0	0%
Student Center	100,793	102,120	(1,327)	(1%)	99,136	110,760	(11,624)	(12%)
Inactive/Conversion Space	90,272	0	90,272	100%	16,195	0	16,195	100%
<b>Other Subtotal</b>	<b>1,314,868</b>	<b>974,533</b>	<b>340,335</b>	<b>26%</b>	<b>1,194,817</b>	<b>1,048,668</b>	<b>146,149</b>	<b>12%</b>
<b>CAMPUS TOTAL</b>	<b>2,296,254</b>	<b>1,621,688</b>	<b>674,566</b>	<b>29%</b>	<b>2,049,494</b>	<b>1,689,927</b>	<b>359,567</b>	<b>18%</b>

\*\* A campus is typically balanced at a surplus/deficit of +/-10%

Assumptions: A potential student enrollment increase and projected staff reductions are included in the Target analysis; College of Medicine space needs are not included; The surplus indicates that there is sufficient quantity of space on campus



A photograph of a large, multi-story brick building with a white balcony, set against a backdrop of trees with autumn foliage. A red rectangular box is overlaid in the center of the image, containing white text. The foreground is a green lawn with a low hedge.

## **PLAN GOALS & PREFERRED SCENARIO**



# CAMPUS TODAY





# CAMPUS VISION

INTERDISCIPLINARITY

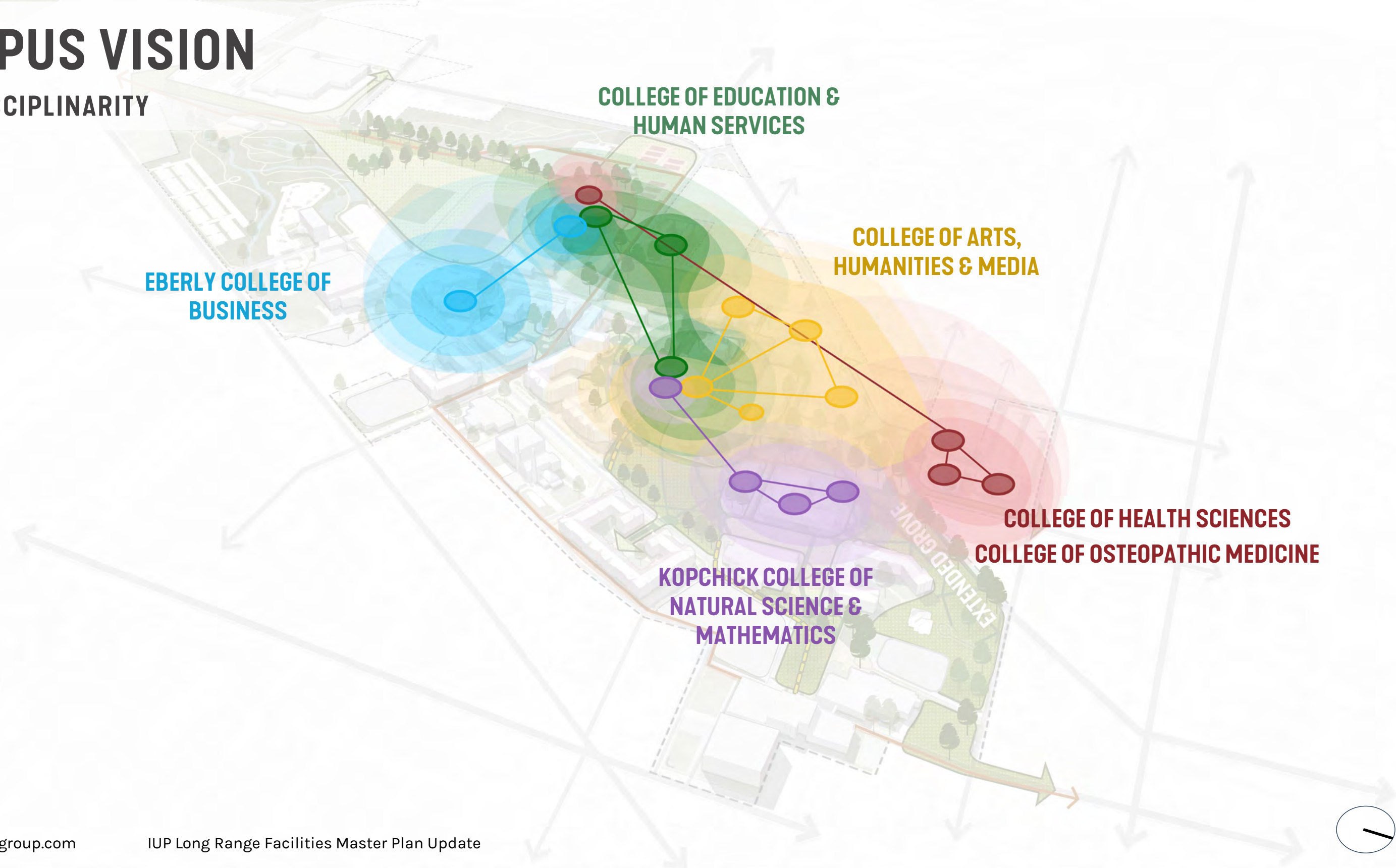



# CAMPUS VISION

STUDENT-CENTERED

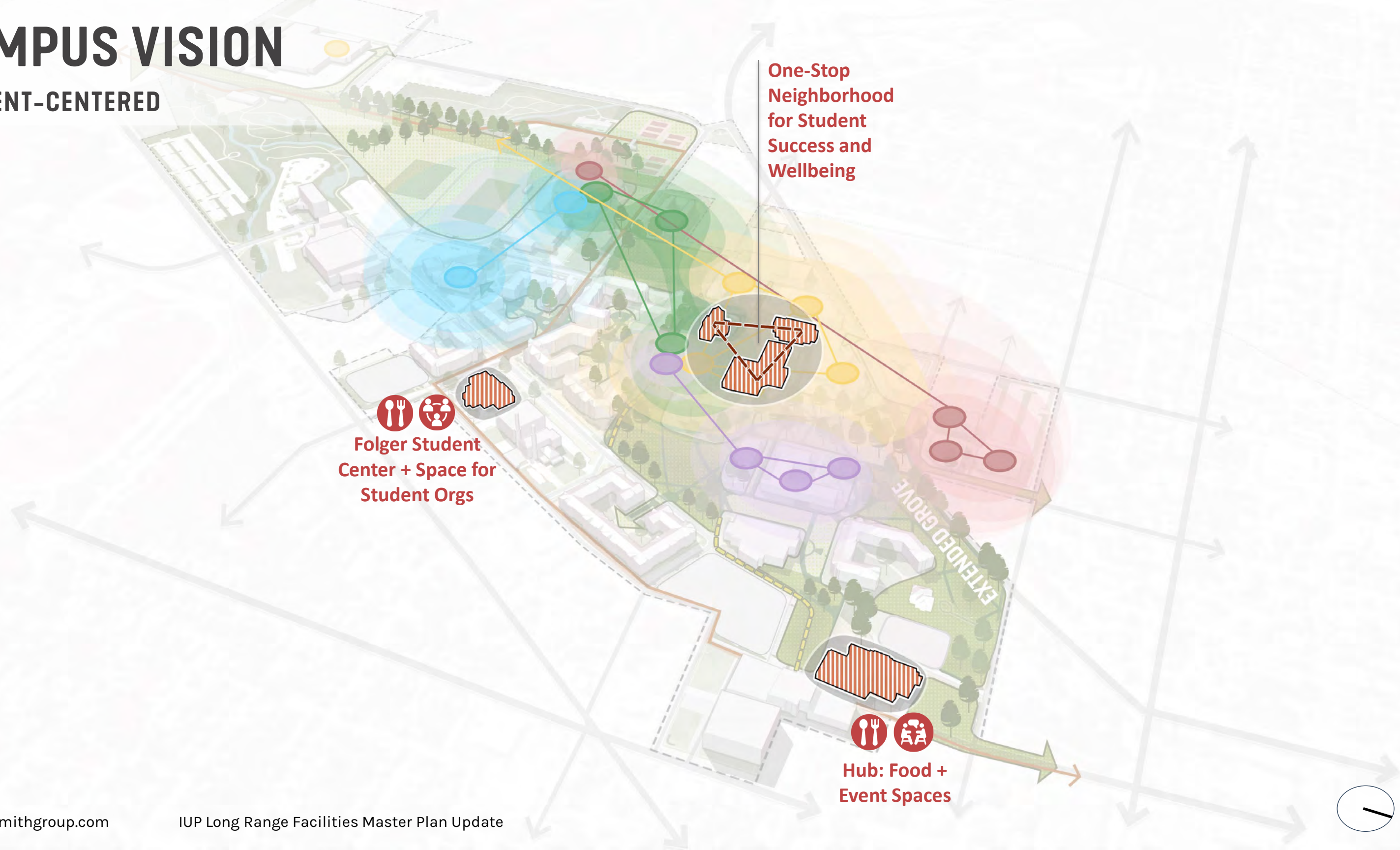



# CAMPUS VISION



- Renovation
- Transformation
- New Construction



# CAMPUS TODAY

## BUILDINGS APPROVED FOR DEMOLITION



 Buildings Approved for Demolition



# CAMPUS POST-DEMOLITION



Oak Grove



# PRESENT ACADEMIC SCENARIO



COLLEGE OF ARTS, HUMANITIES & MEDIA

COLLEGE OF EDUCATION & HUMAN SERVICES

COLLEGE OF HEALTH SCIENCES

EBERLY COLLEGE OF BUSINESS

KOPCHICK COLLEGE OF NATURAL SCIENCE & MATHEMATICS





# ACADEMIC FUTURE

## COLLEGE OF ARTS, HUMANITIES & MEDIA

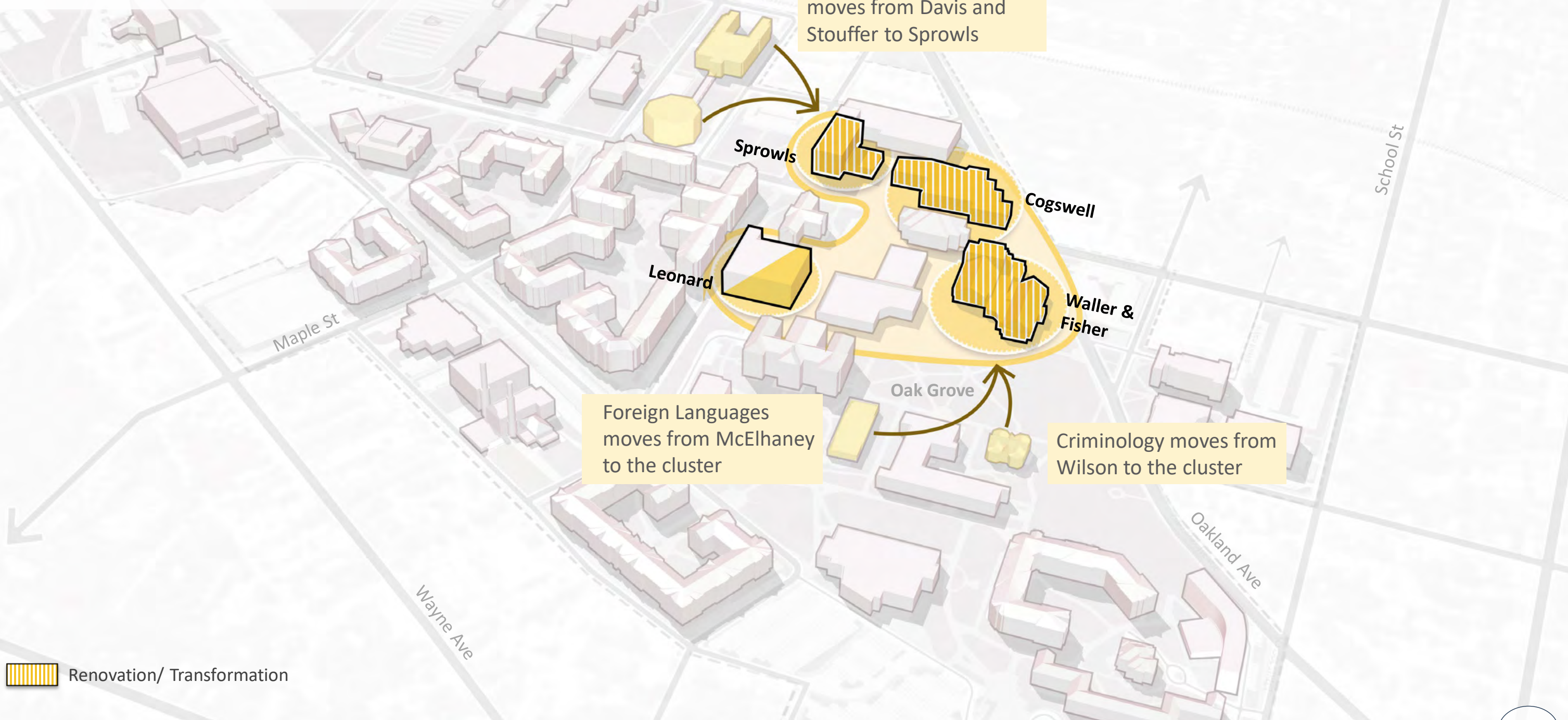

 Renovation/ Transformation





# ACADEMIC FUTURE

## COLLEGE OF EDUCATION & HUMAN SERVICES

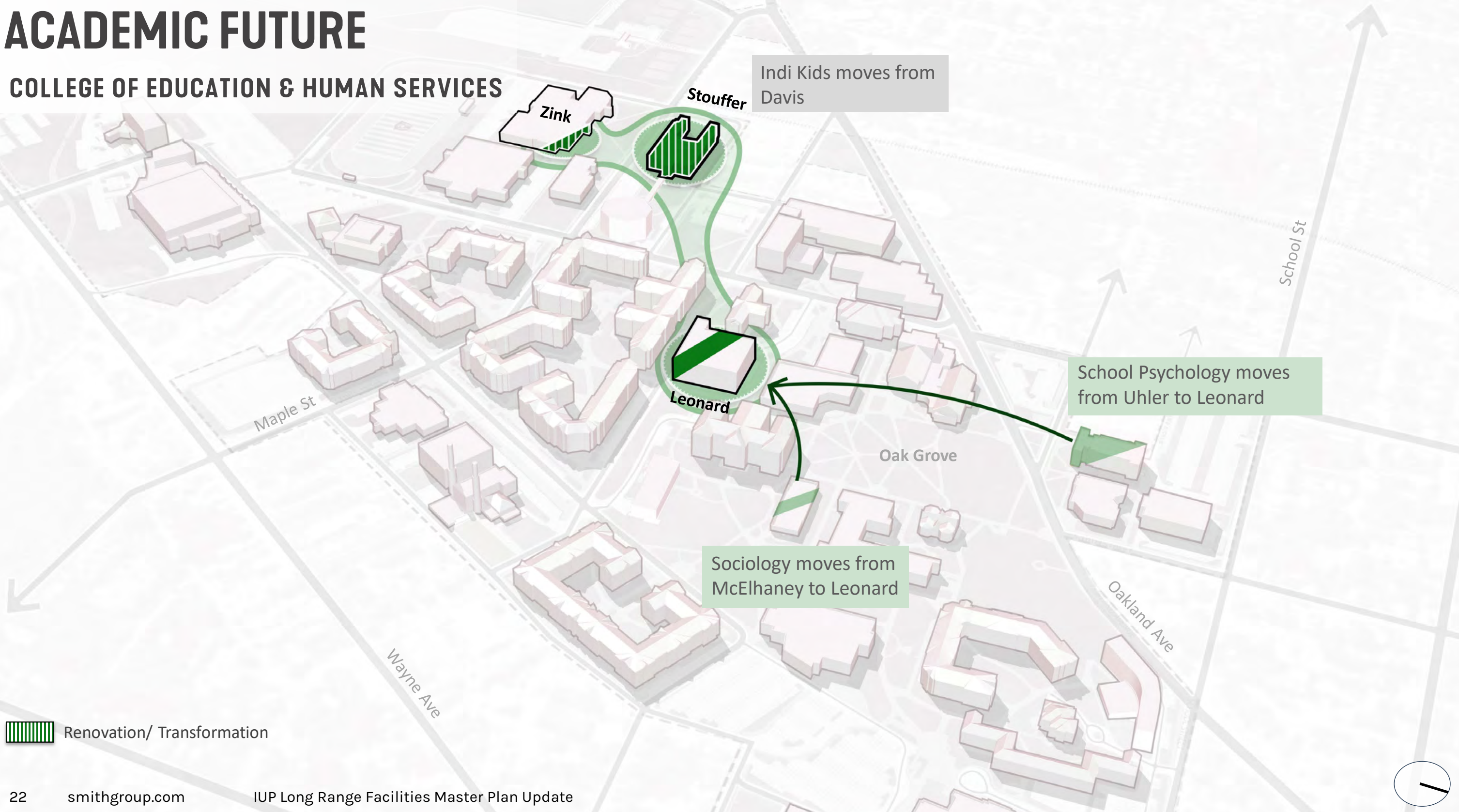

Indi Kids moves from Davis

School Psychology moves from Uhler to Leonard

Sociology moves from McElhaneey to Leonard

 Renovation/ Transformation





# ACADEMIC FUTURE

## COLLEGE OF HEALTH SCIENCES + COLLEGE OF OSTEOPATHIC MEDICINE

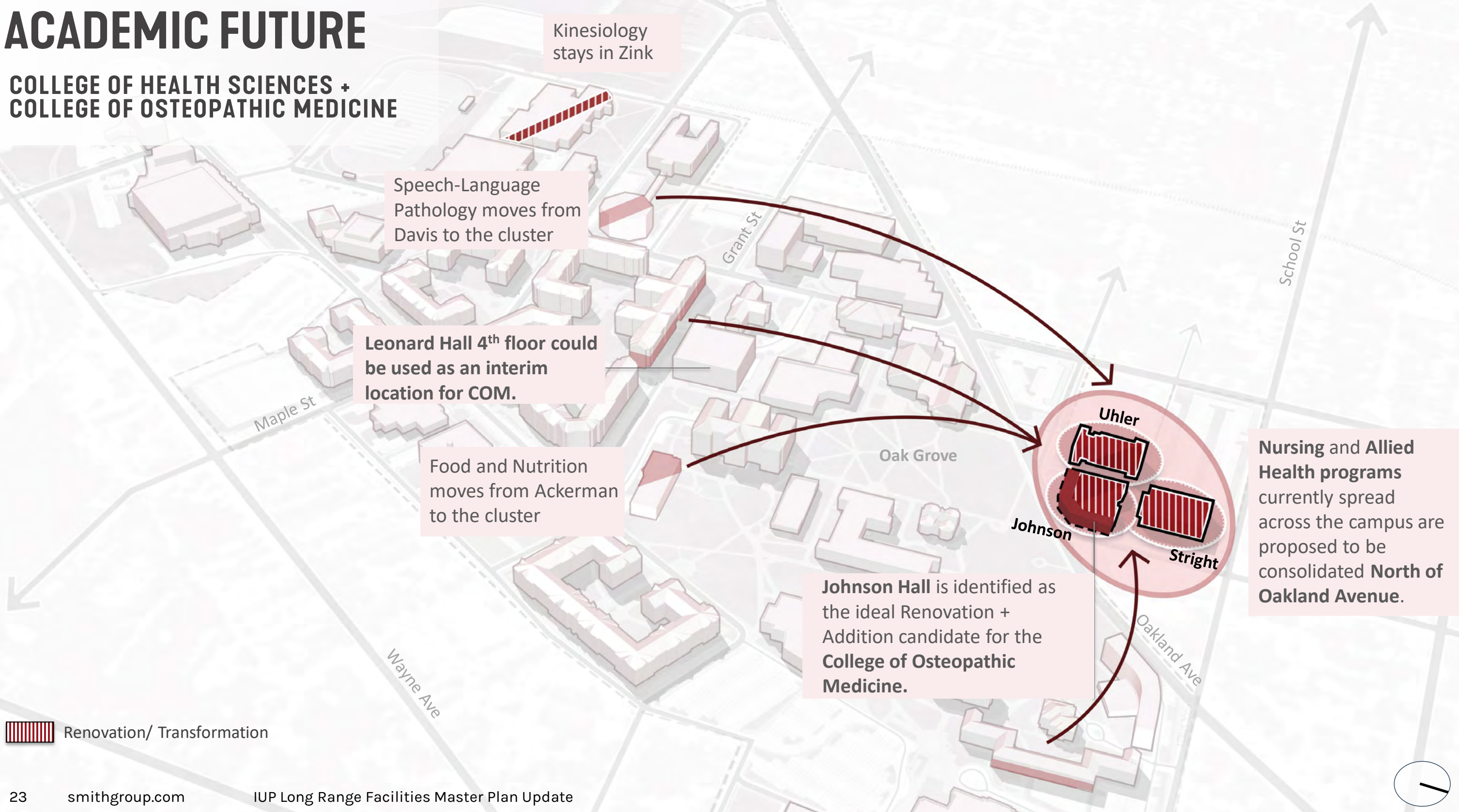

 Renovation/ Transformation





# ACADEMIC FUTURE

## HEALTH SCIENCES + OSTEOPATHIC CLUSTER

- **Johnson Hall** is identified as the ideal Renovation + Addition candidate for the **College of Osteopathic Medicine**.
- **Nursing and Allied Health programs** currently spread across the campus are proposed to be consolidated **North of Oakland Avenue**.
- Proposed Improvements in Pedestrian Connectivity across Oakland Avenue tie the Cluster to the Campus Core.





# HEALTH SCIENCES CLUSTER





# ACADEMIC FUTURE

## COLLEGE OF NATURAL SCIENCES & MATHEMATICS

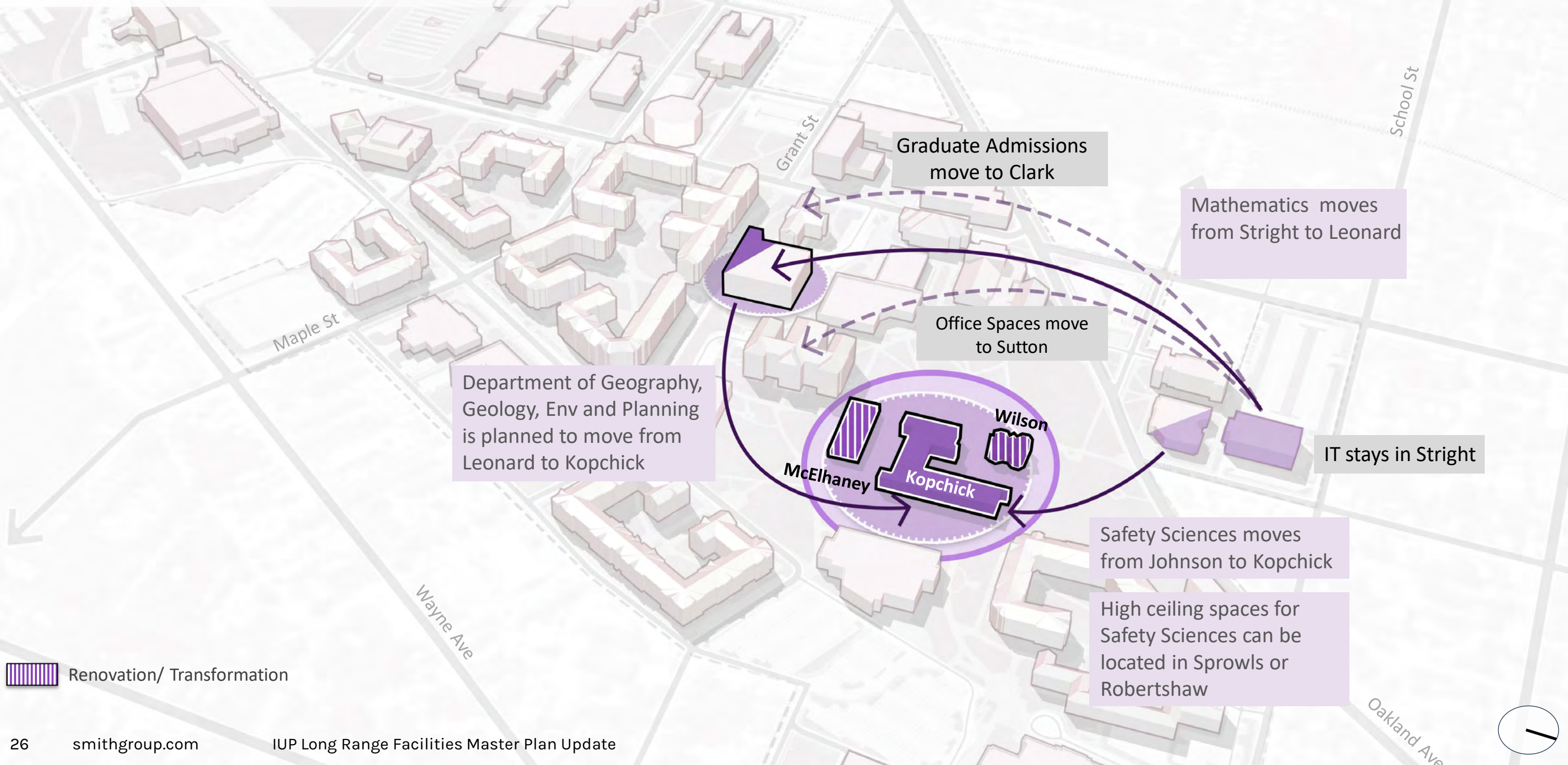

 Renovation/ Transformation





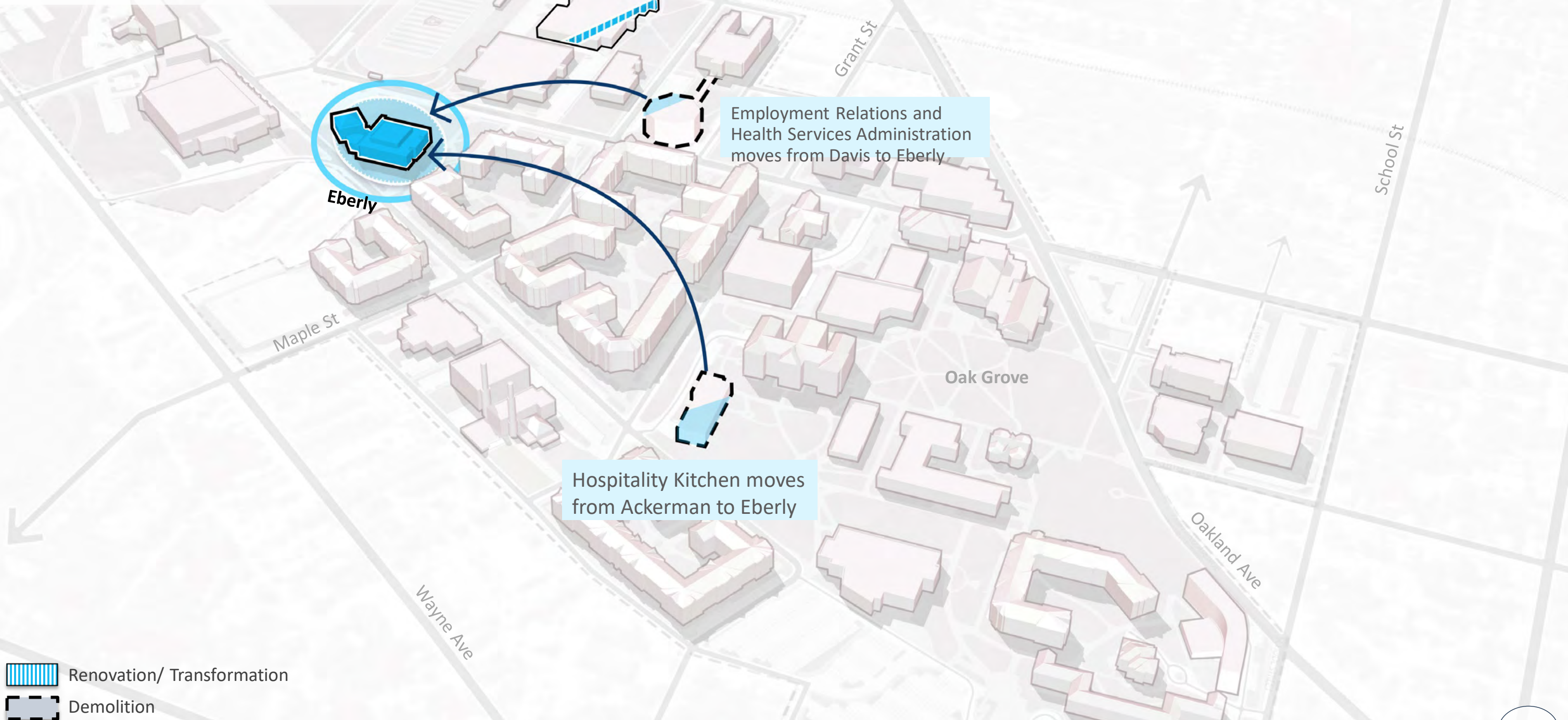

# ACADEMIC FUTURE

## EBERLY COLLEGE OF BUSINESS



-  Renovation/ Transformation
-  Demolition





# ACADEMIC FUTURE

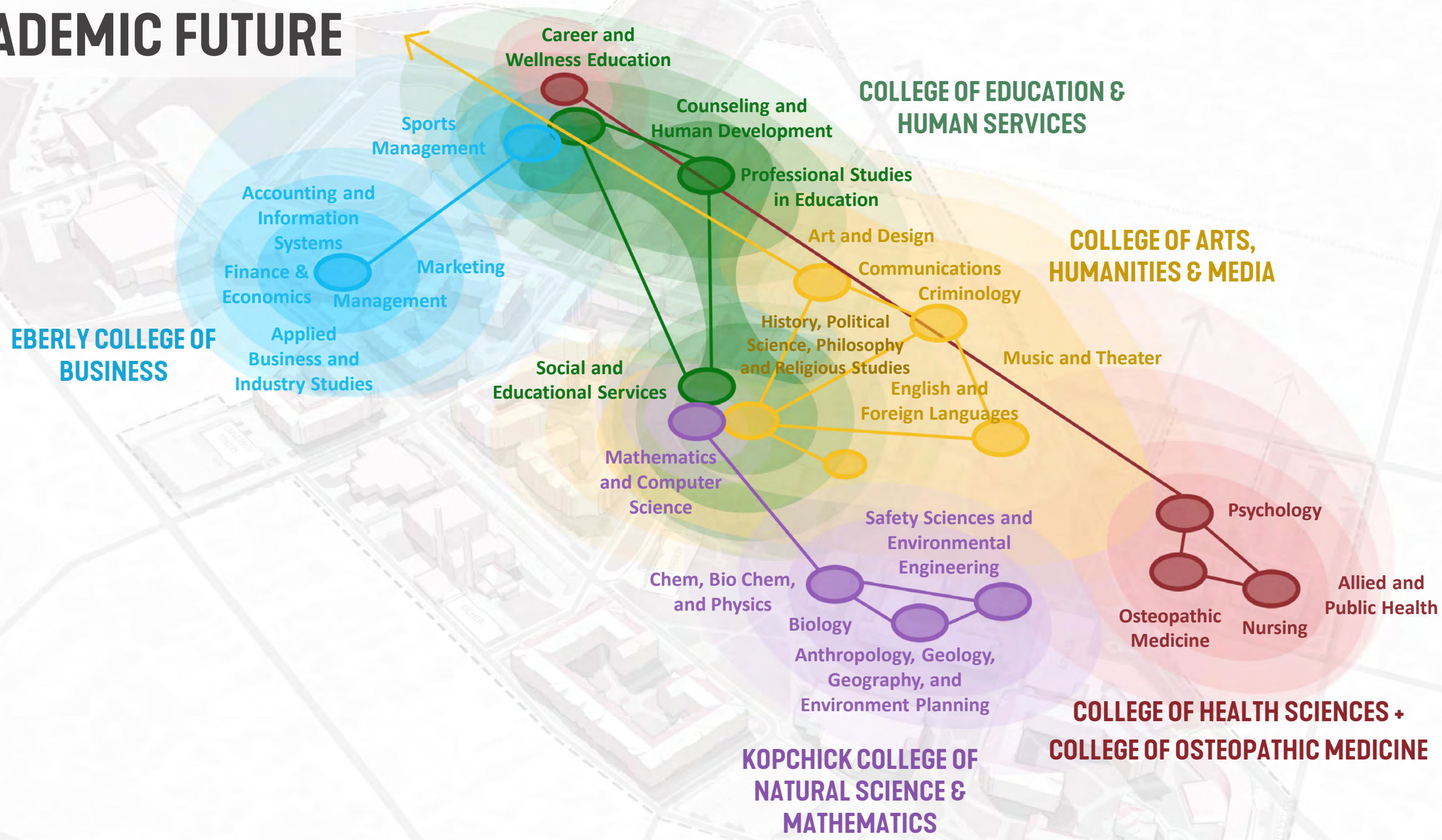



# STUDENT SUCCESS & WELLBEING

## ONE-STOP FOR STUDENTS

- The Gateway for prospective students and visitors is reimagined through the Parking garage leading to the One-Stop Neighborhood.
- **Crimson Café, Clark, and Library** are identified as the key buildings for student resources like the Welcome Center, Admissions, Registration, Career Resources, Life Design Program, etc.
- The **Synergized One-Stop Neighborhood** for Student Success Resources enhances the everyday student experience.

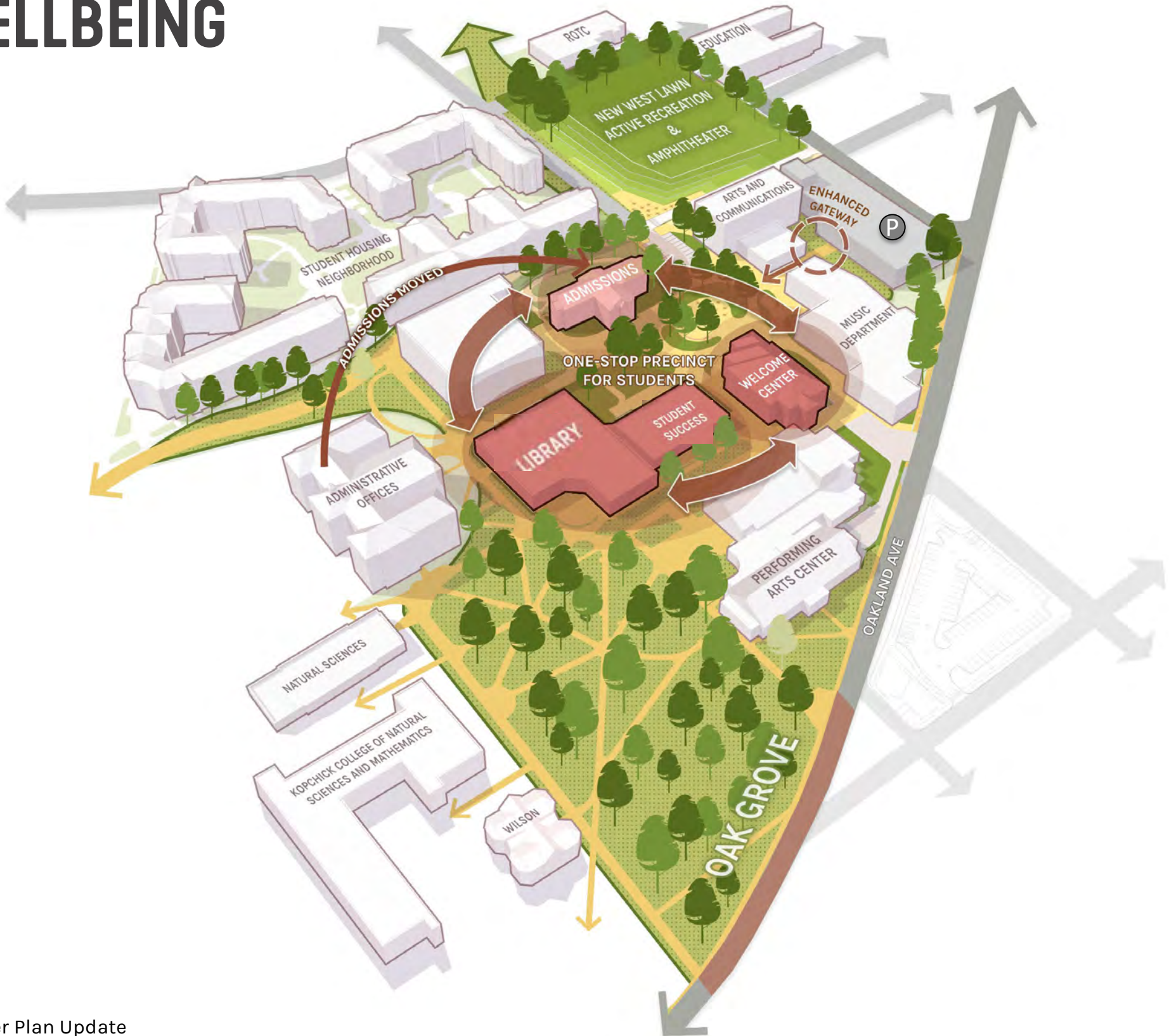



WELCOME



Welcome Center

IUP

IUP

Sprowls Hall



# CAMPUS COMMUNITY

## THE ECOSYSTEM

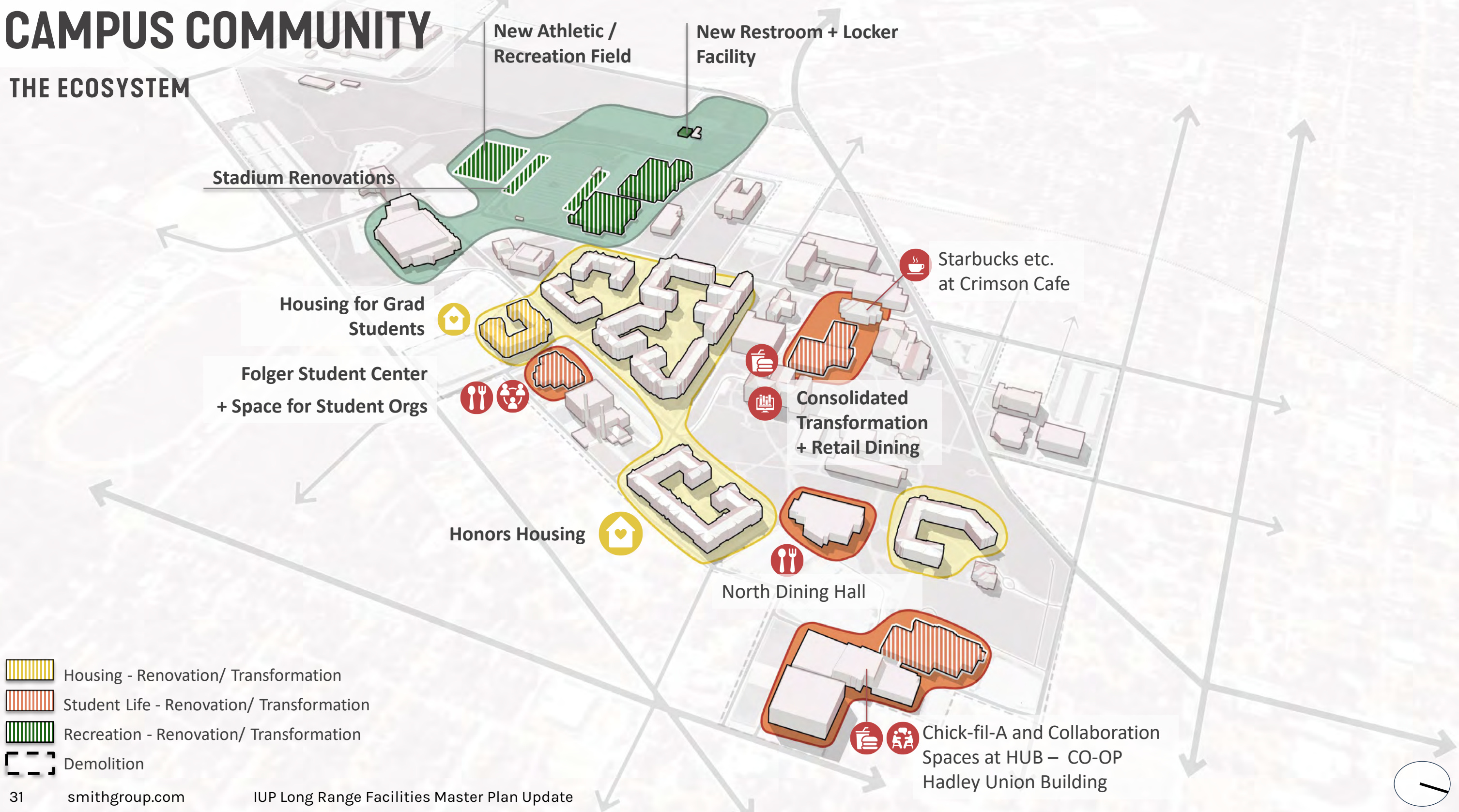

New Athletic /  
Recreation Field

New Restroom + Locker  
Facility

Stadium Renovations

Housing for Grad  
Students

Folger Student Center  
+ Space for Student Orgs



Honors Housing



North Dining Hall



Consolidated  
Transformation  
+ Retail Dining



Starbucks etc.  
at Crimson Cafe



Chick-fil-A and Collaboration  
Spaces at HUB – CO-OP  
Hadley Union Building



- Housing - Renovation/ Transformation
- Student Life - Renovation/ Transformation
- Recreation - Renovation/ Transformation
- Demolition





# MOVING AROUND CAMPUS

## VEHICULAR NETWORK

Distinct Pavement for Traffic Calming

Additional Parking at Kovalchick site

Reduced and Reconfigured Parking

- Existing Street Network
- Removed Streets
- Safer Pedestrian Crossings
- New/Modified Parking
- EV Charging Stations

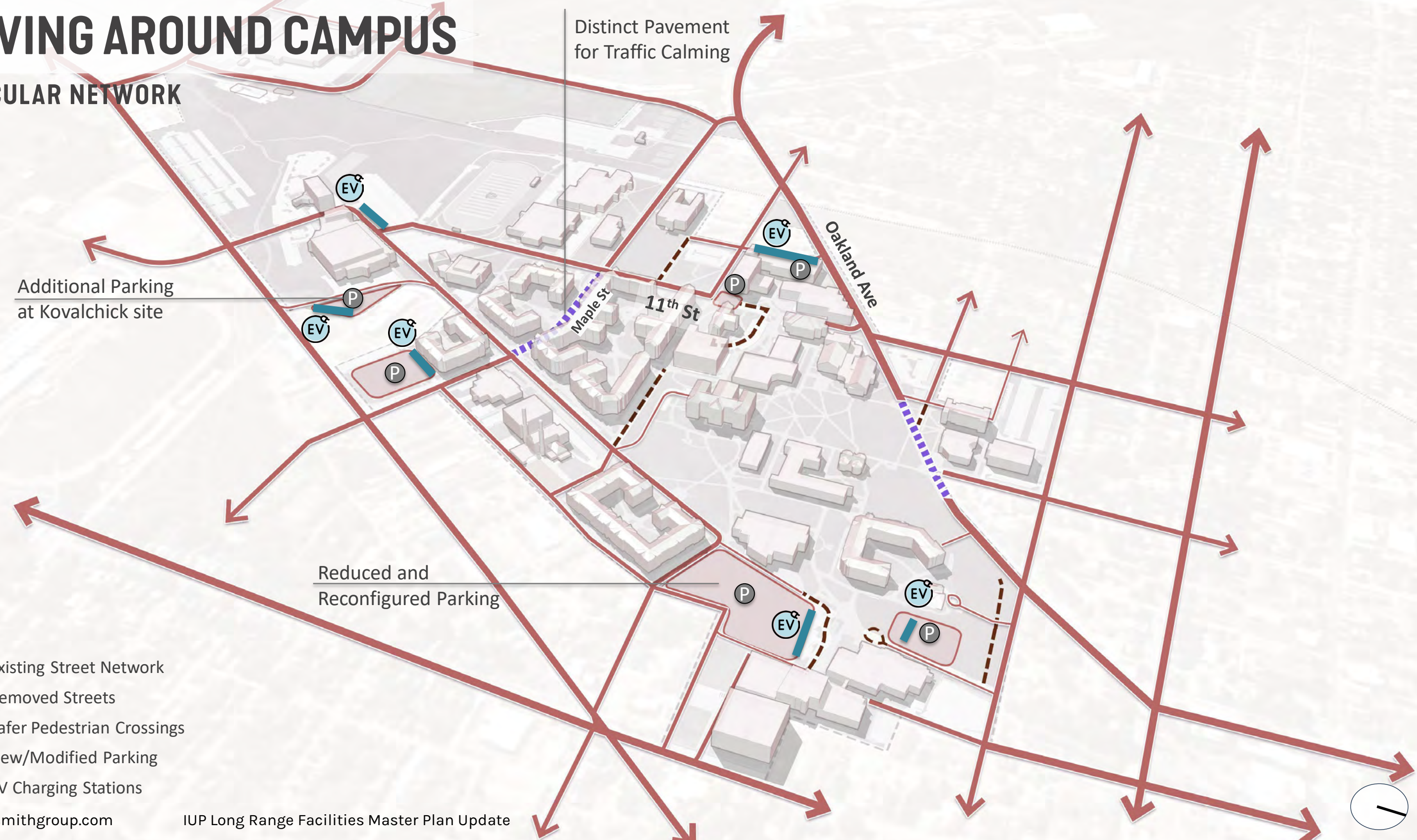



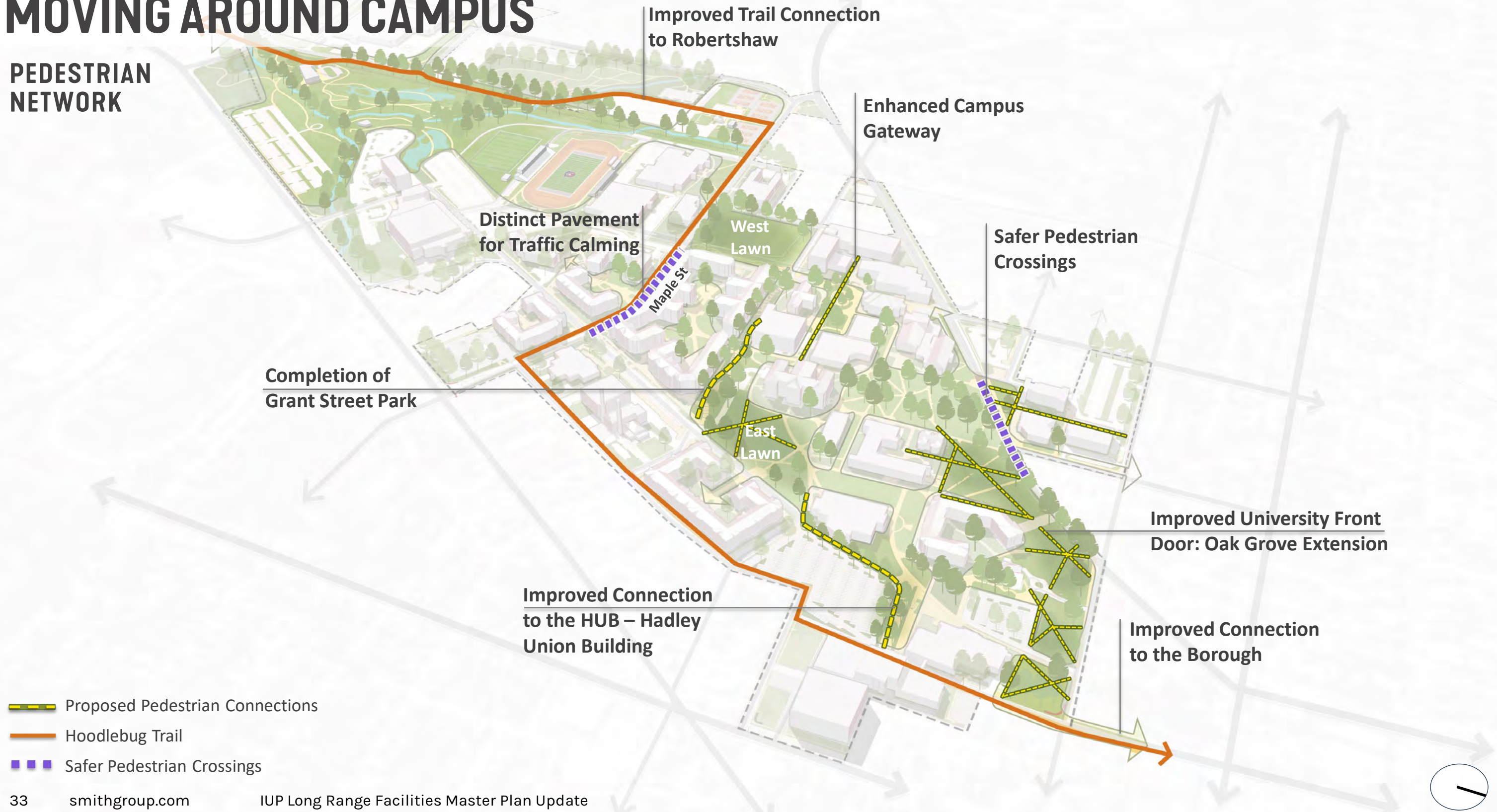

# MOVING AROUND CAMPUS

## PEDESTRIAN NETWORK





-  Proposed Pedestrian Connections
-  Hoodlebug Trail
-  Safer Pedestrian Crossings

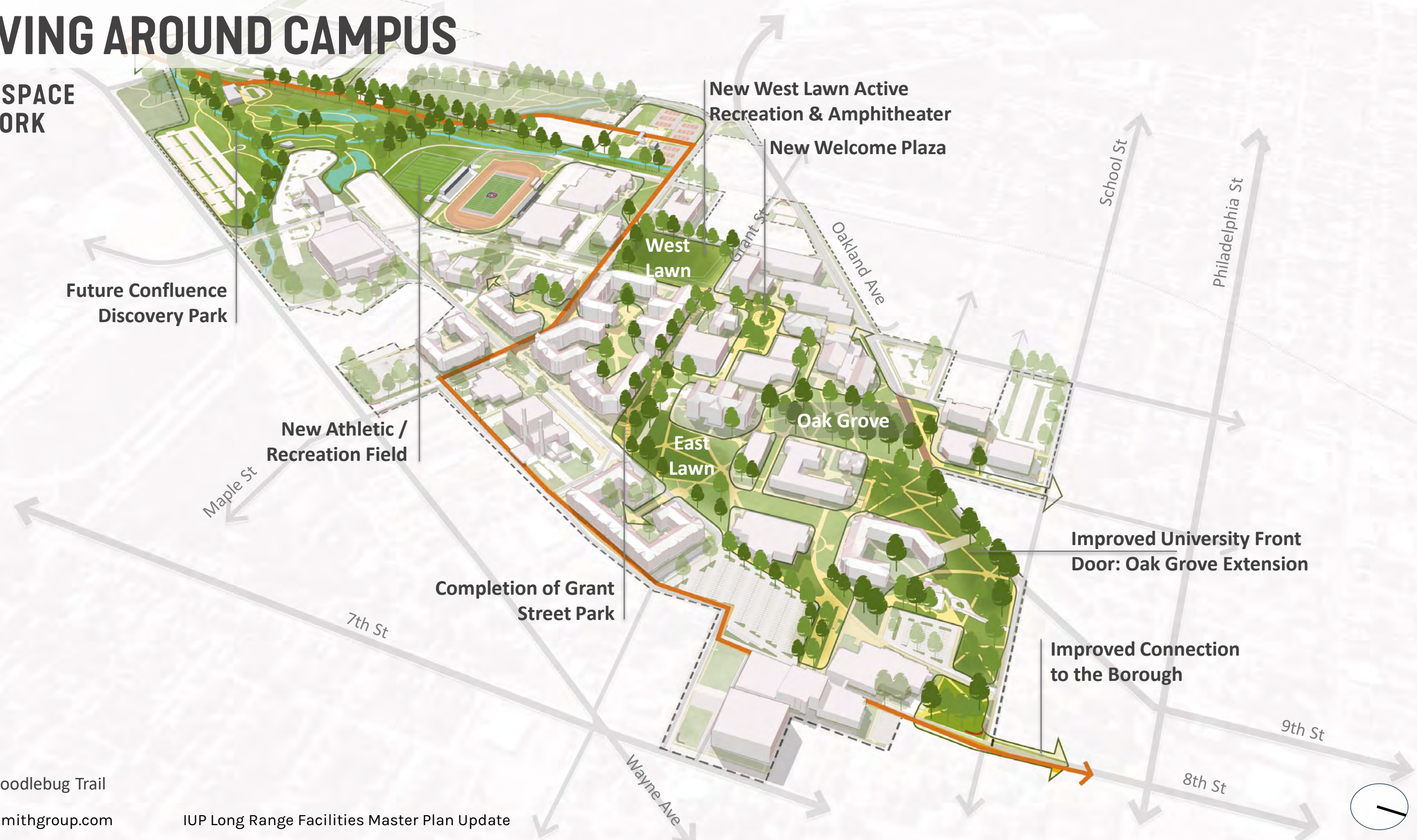

# MOVING AROUND CAMPUS

## OPEN SPACE NETWORK



 Hoodlebug Trail



# WEST LAWN & AMPHITHEATER



Sprowls Hall

Putt Hall

IUP



# CAMPUS & THE BOROUGH

Miller Stadium  
Renovation  
KCAC

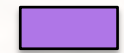
-  Enhanced Campus Gateway
-  Potential Public-Private Partnership (P3) Opportunities

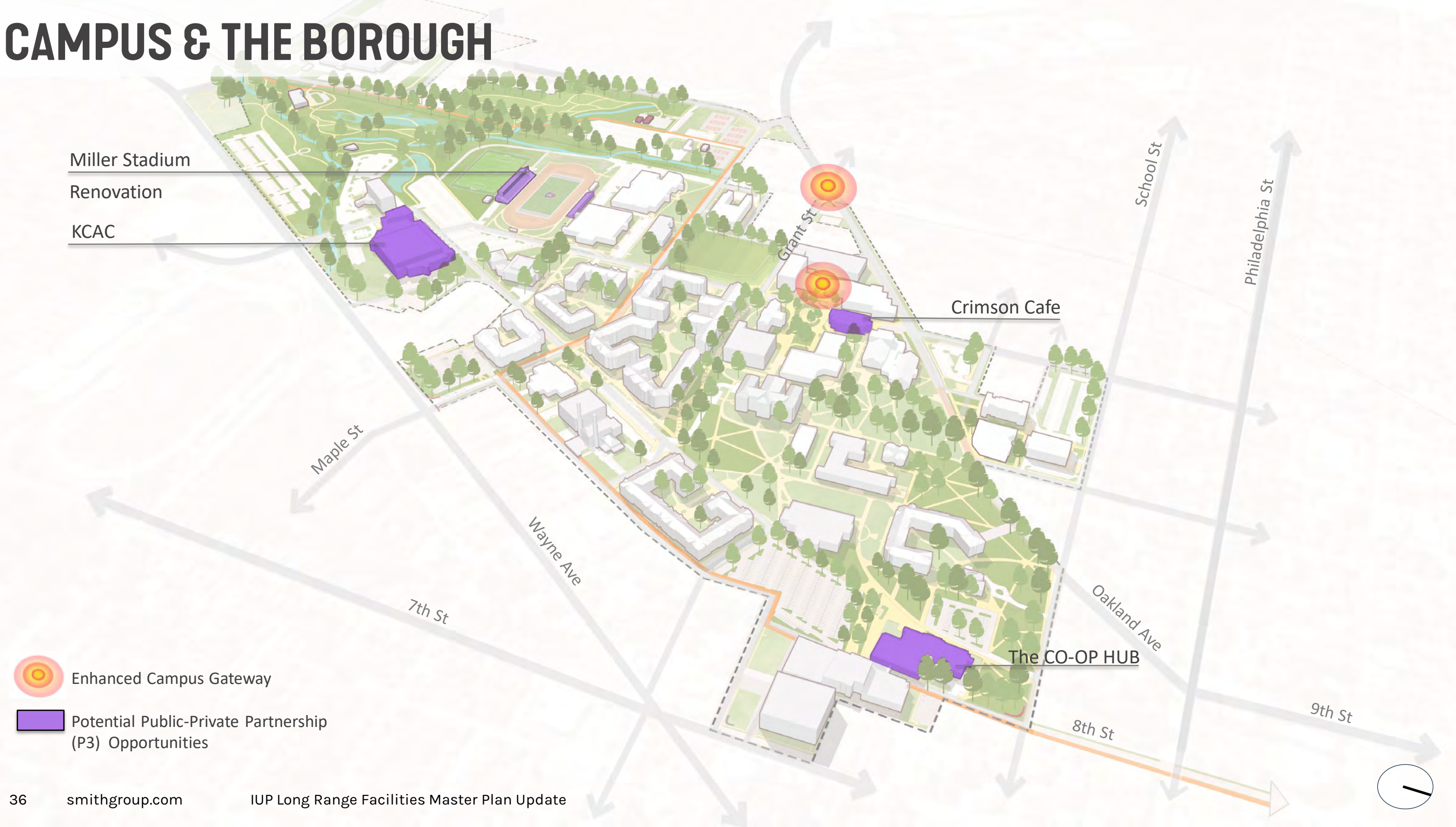



# CAMPUS VISION

## KEY THEMES

- Promotes shared use of resources and fosters interdisciplinarity.
- Outlines the **New College of Osteopathic Medicine: Renovation + Addition of Johnson Hall.**
- Relocates the **College of Health and Human Services Cluster North of Oakland Avenue**, renovating Johnson, Uhler, and Stright.
- Creates a **One-Stop Neighborhood for Student Success**, renovating Crimson Café, Clark, and the Library.
- Proposes a new **“Campus Front Door”** highlighting the Extended Oak Grove, new College of Osteopathic Medicine & Health Cluster, and improved Connection to downtown.
- Creates a **New Active Green Space (West Lawn)** at the site of Foster and Davis.

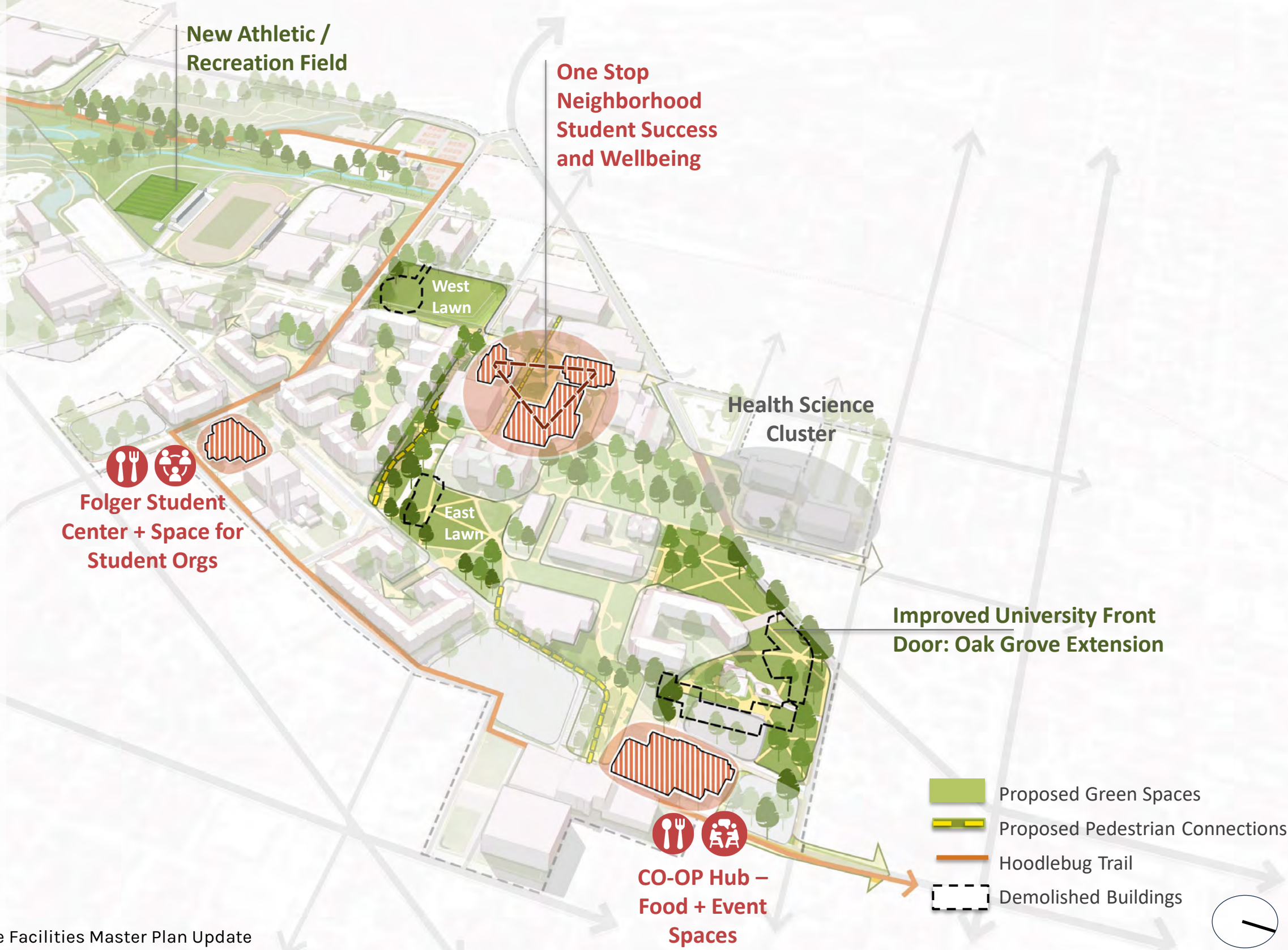



# CAMPUS VISION



- Renovation
- Transformation
- New Construction





# CAMPUS VISION



- Building Renovation
- Building Transformation
- New Construction/Addition

## SITE IMPROVEMENTS

- 01 Oakland Avenue Pedestrian Improvement
- 02 The Extended Grove
- 03 New Parking Lot & Drop-Off at Pratt Dr
- 04 New Pedestrian Connection from Wallwork Hall to HUB
- 05 Reconfigured HUB & Keith Parking Lots
- 06 East Lawn (Enhanced Green Space)
- 07 Grant Street Park Completion
- 08 Welcome Plaza
- 09 West Lawn & Amphitheater (New Green Space)
- 10 Expanded Parking at Suites on Pratt
- 11 Maple Street Pedestrian Improvements
- 12 Expanded Parking at KCAC
- 13 New Multipurpose Field
- 14 Improved Trail Connection to Robertshaw
- 15 Confluence Discovery Park
- 16 New Synthetic Soccer Turf

## BUILDING IMPROVEMENTS

- 01 Johnson Hall Transformation and Addition
- 02 Uhler Hall Renovation
- 03 Stright Hall Transformation
- 04 Hadley Union Building (HUB) Renovation
- 05 McElhane Hall Renovation
- 06 Wilson Hall Renovation
- 07 Crimson Café as the Welcome Center
- 08 Clark Hall as the Admissions Office
- 09 Library Transformation
- 10 Sprowls Transformation
- 11 Performing Arts Center Renovation
- 12 Cogswell Renovation
- 13 Stouffer Renovation
- 14 Folger Student Center Transformation
- 15 Suites on Pratt as New Graduate Housing
- 16 Memorial Field House Renovation
- 17 Zink Renovation
- 18 George P. Miller Stadium Improvements
- 19 New Restroom & Locker Facility
- 20 New Restroom Facility

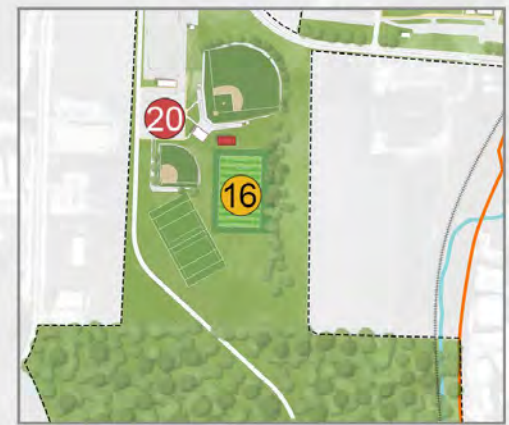

South Campus Fields



**Thank you!**



**IUP**



# What are the next steps in the LRFMP and with the physical moves with the Academic Program Review and Restructuring?



Dr. Debra L. Fitzsimons

Dr. Lara Luetkehans



# Steps to Finalizing the LRFMP information

*The Council of Trustees formally endorsed the resolution that outlined the criteria and components of the LRFMP in January of 2024.*

*After their January approval, the Smith Group Consultants have been developing the LRFMP Report based on the criteria and components that was approved.*

- The detailed LRFMP report will be provided to IUP within the next two weeks.
- The detailed LRFMP report will be reviewed internally by IUP and developed into an agenda item for discussion with the Council of Trustees.
- The detailed report will be discussed with the Council of Trustees at the **May 9<sup>th</sup> COT meeting**, after which any feedback will be incorporated and it will be finalized and published.



# Steps to Finalizing the LRFMP information

*At the same time that the LRFMP detailed report is being developed and reviewed, the Academic Restructuring Implementation Advisory Committee is working on their recommendations.*

*ARIA has been charged with developing a set of guidelines and recommendations to support the Academic Restructuring Plan.*

- They are tasked with identifying transition issues and tasks, establish timelines, develop procedures and monitor progress toward implementing the redesigned academic structure related to:
  - Academic Records, Budget, Connections and Innovations, College/Department, Communications, Curriculum, **Facilities**, Program Review and Accreditation, Personnel, Shared Governance, Student Success, and Reflections and Dissemination of Lessons Learned
- The recommendations from ARIA are currently being finalized.



# Steps to Finalizing the LRFMP information

***The LRFMP has incorporated components of the Academic Program Review and Restructuring into the plan, dovetailing the academic planning with the Long Range Facilities Master Planning.***

***The LRFMP Report will be recommending projects identified to be done by Phases.***

- The LRFMP Phase I will incorporate the information from the APRR related to physical space requirements.
- LRFMP Phase I is intended to take 0-5 years, depending on complexity, funding, etc.
- There will be implementation details further fleshed out from the academic program review and restructuring and the LRFMP Report Phase I items that can be done over this summer, next year, and over the next few years.
- Some of the moves and changes are more simple, while others are much more complicated.
- Some of the changes will require facilities planning, dollars to be identified, and have multiple steps involving many individuals or departments. Some of the multiple steps have domino effects.



# Steps to Finalizing the LRFMP information

*The LRFMP Phase I Implementation needs to be carefully planned out.*

*The planning will include working with impacted colleges, departments, individuals.*

- **As an example of a “simple” move:** There may be some individual departments that can move fairly early in the implementation of the LRFMP Phase I. Even so, the move would still need to be carefully planned so that all items related to the move are taken care of. Checklists will be identified that would include all aspects around the physical move, security, web changes, phones, internet, signage, etc. It needs to be organized and planned out well so that the facilities staff and departments involved in the move are well coordinated.
- Other more complex moves need to be well-planned so that renovations can be completed.
- **The month of May will be used to plan out the sequencing and more immediate (0-9 months) next steps in the LRFMP Phase I.**
- **We do not expect any individuals to be moving to a new location in the month of May,** but we will be reaching out to departments to begin discussions after the May COT meeting takes place and after further discussions with the provost.



# Steps to Finalizing the LRFMP information

***To Recap: Don't pack your bags quite yet!***

***After the recommendations from ARIA and the LRFMP report are received, reviewed and approved, the sequencing and implementation steps will be developed and refined.***

- Impacted departments will be contacted and we will work through details of implementation including timing, departmental needs, etc.
- We will ensure that there will be sufficient support and consideration of employee contractual periods as we develop the planning.
- Sufficient notice will be provided.
- Departments impacted by any of these moves will not have to pay for costs associated with the academic program review and restructuring or with the LRFMP Phase I implementation relocations.
- We will communicate with the IUP campus community on recommended implementation steps for Summer 2024 and next academic year 2024-2025, so we are collectively prepared.
- ***We will commit to communicating and listening a lot throughout the process as we work on these next implementation steps together.***



Thank you!



IUP